

C WIRE ADAPTER



Installation Guide

Guía de instalación
Guide d'installation

Online Guides and Support

Guías en línea / Guides en ligne

customer.honeywell.com



33-00342-01

Overview

This product replaces the need for a C wire (common wire) to power a thermostat. Only install if you do not have a C wire available to connect to your thermostat.



ZONING CONTROL PANEL CHECK

For zoned systems, install the C Wire Adapter between the thermostat and the zoning panel, **NOT** between the zoning panel and HVAC equipment.

BEFORE



AFTER

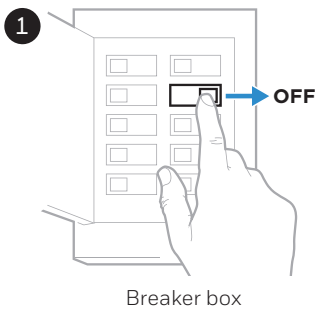
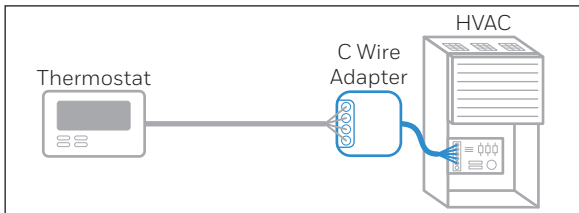

Breaker box

Turn the power off at the breaker box or control switch for your HVAC* system.



Switch

*Heating, ventilation, and air conditioning

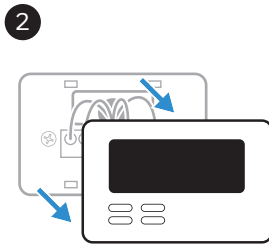

Remove your old thermostat from the wall plate.



Do not remove any wires at this time!



Take a picture of the wiring.

Ensure the terminal labels and wires are in the image.

You may need to reference the picture later.

Wires
Terminal Labels

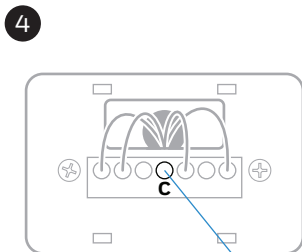

Confirm that you do not have a wire in the C terminal.

If you have a wire in the C terminal, then you do not need this product.

C terminal

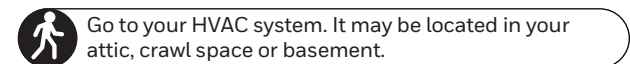

Go to your HVAC system. It may be located in your attic, crawl space or basement.

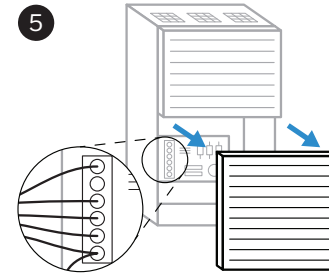

Open HVAC system's cover to reveal the control board.

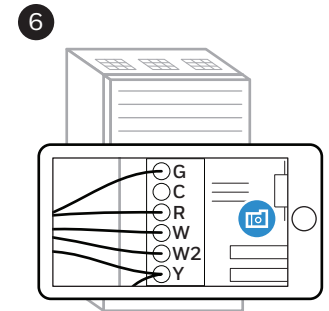

Take a picture of the wires on the control board.

Ensure the terminal labels and wires are in the image.

You may need to reference the picture later.

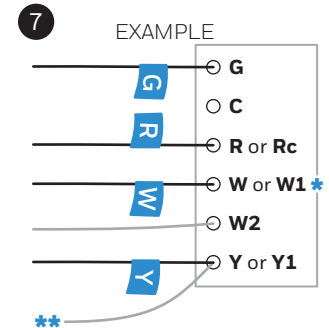

EXAMPLE

Use the provided stickers to label the following connected wires:

- G
- R or Rc
- W or W1
- Y or Y1

* Not all systems will have a W or W1-wire.

** If multiple wires are connected to a terminal, only label the the wire running to your thermostat.

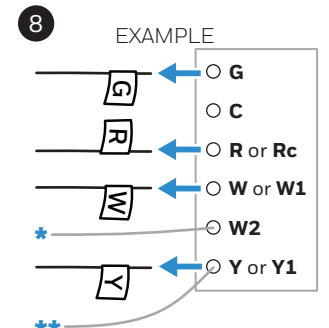

EXAMPLE

Disconnect **ONLY** the wires that you just labelled:

- G
- R or Rc
- W or W1
- Y or Y1

* Do NOT disconnect wires that you did not label.

** If multiple wires are connected to a terminal, only remove the the wire running to your thermostat.

CONTINUE ▶

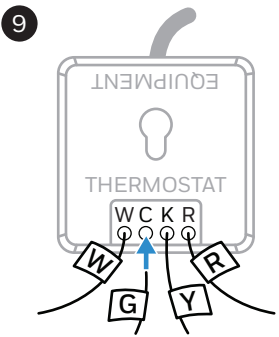

Insert the wires you just disconnected into the C Wire Adapter terminals.

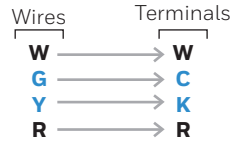

This will convert the G and Y-wires into C and K-wires.

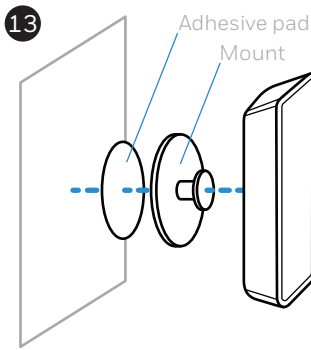

Mount C Wire Adapter inside the furnace using included mount and adhesive pad.

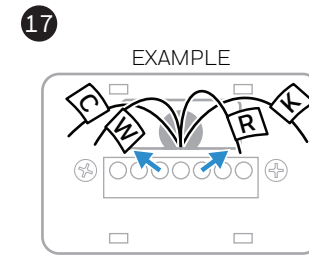

Confirm you have labelled ALL of your wiring.

Disconnect the wires from the old wall plate.

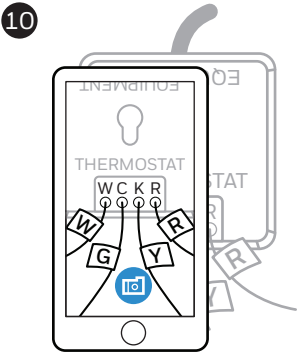

Take a picture of the wires you inserted into the C Wire Adapter.

Ensure the terminal labels and wires are in the image.

You may need to reference the picture later.

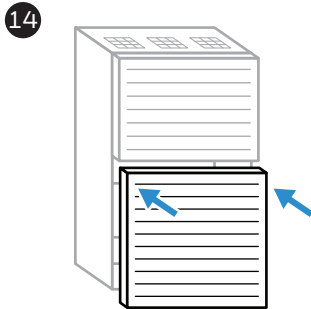

Close the HVAC system's cover.

⚠ Leave the power off.

18 NEXT STEPS

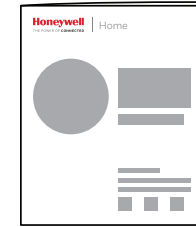

Refer to your new thermostat's installation guide for detailed instructions to complete the following tasks below.

A Remove the old wall plate and mount the new one.

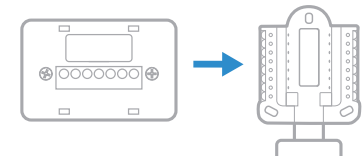

B Wire the new thermostat.

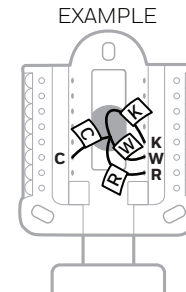

⚠ Refer to the labels you applied when inserting the wires.

When done wiring, you should have wires in the C and K-terminals.

You should not have wires in the Y or Y1 or G-terminals.

C Complete your new thermostat's installation by attaching the thermostat to the wall plate, restoring the power, & configuring the thermostat.

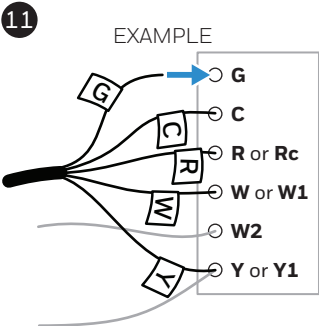

Connect the wires from the "Equipment" labelled side of the C Wire Adapter to the matching terminals on the control board.

Go back to your thermostat.

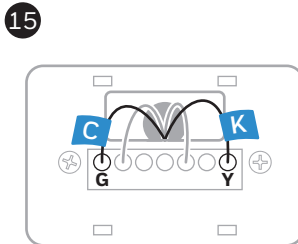

Label your now converted wires as shown.



The wires you label C and K are the wires you inserted into the C and K-terminals in step 9.

12 CHECKPOINT

Your C Wire Adapter should now be installed between your thermostat wiring and the control board.

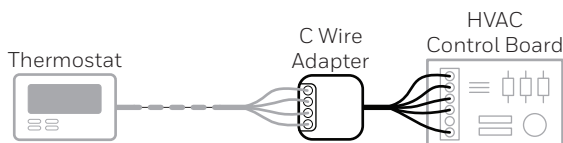

Label ALL of the remaining wires according to their terminals.

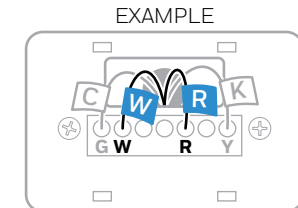

Home and Building Technologies

Honeywell
715 Peachtree Street NE
Atlanta, GA 30308
customer.honeywell.com

*U.S. Registered Trademark
©2017 Honeywell International Inc.
33-00342-01 M.S. 09-17
Printed in U.S.A.