

Warnings about Installation of Receivers

- The wireless remote uses a very weak infrared light for its signal, which can result in the signal not being received because of the following influences, so take care in where the unit is installed.
 - Inverter or rapid-start type fluorescent lights. (Models without glow lamps)
 - Plasma display or LCD televisions.
 - Direct sunlight or other sources of bright light.

Warnings about Installing Remote Controllers

- If a remote controller is to be operated from a remote control holder that is hung on a wall, turn on the lights in the room as well as any electrical appliances and then check to make sure the air conditioner works with the remote controller in the location where it will be installed. If it works, continue with installation.
- If the air conditioner is to be switched from the main sensor to a remote control sensor, pay attention to the following when installing.
 - Locate where no warm or cold drafts will affect it.
 - Locate in a place free from direct sunlight.
 - Locate where it will not be affected by any other heat/cold source.

Customer Explanation

- Give the Operating Instructions and this manual to the customer after finishing the installation.
- Use the Operating Instructions to explain to the customer how to use and care for the unit.

Things to remember when wired and wireless remotes are installed at the same time

Two remote controllers can be used to control the unit if the wireless remote controller is installed at the same time as the wired remote controller.
(Up to 2 remotes [a wireless remote controller and the wired remote controller] can be installed.)
When using 2 remotes, one or more units can be operated by the remotes.

<Note> When wiring remote controllers, be sure to double-check the terminal numbers of the indoor unit before connecting them so there are no mistakes in the wiring. (Damage will occur if high voltage [e.g. supply voltage] is applied.)

<Note> It is not possible to use more than one wireless remote controller with one indoor unit. (A receiver located separately can be used at the same time.)

<Note> If both a wireless and a wired remote controller are to be installed and used at the same time, one of them must be set up as the sub remote controller.

- If the wired remote controller is to be the sub remote, change the wired remote controller to the sub remote.
- If the wireless remote controller is to be the secondary, turn the #3 switch on the wireless receiver (operation panel) from OFF to ON.

When 1 indoor unit is operated by 2 remote controllers:

※ Either of the remotes can be set to main/sub.

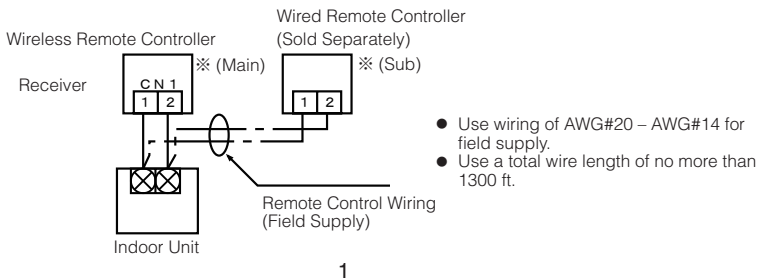

If a group of units are to be controlled by 2 remote controllers;
※ Main/sub remote controllers will work regardless of which indoor unit they are installed to.

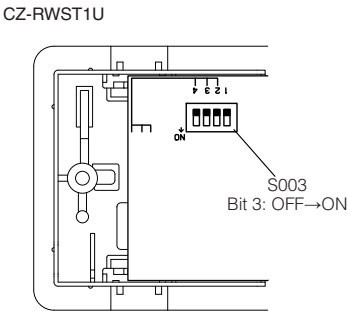
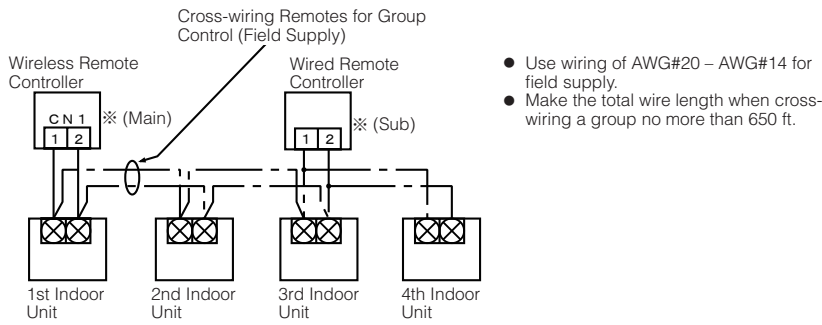

Accessories

No.	Accessories	Quantity	No.	Accessories	Quantity
1	Receiver	1	4	Dry-cell Batteries	2
2	Remote Controller	1	5	Operating Instructions	1
3	Remote Control Holder	1	6	Truss Self-Tapping Screws	2
			7	Cable tie	1

Installing the Receiver

Ceiling Type

- 1 Open the air inlet grill on the side panel, remove the 1 screw and then move it toward the front (direction of the arrow) and remove it. (Fig. A)
 - 2 Wrap the tip of a slotted screwdriver with plastic tape and then slip it in to the side of and under where O is printed on the cover, wiggling the cover free. (Fig. B) (Be careful not to scratch the panel.)
 - 3 After passing the lead wire through the panel, install the receiver in the hole in the panel. (The projecting parts of the receiver is held in the hole in the panel.)
 - 4 Fasten the receiver's lead wire to the cable clip that is holding the wire from the louver motor. (Fig. C)
 - 5 Attach the side panel.
 - 6 Put the receiver's lead wire together with other wires, such as the louver motor wire and fasten them with the wire saddle. (Fig. D)
- Use the hole in the upper part of the wiring box to lead it in.

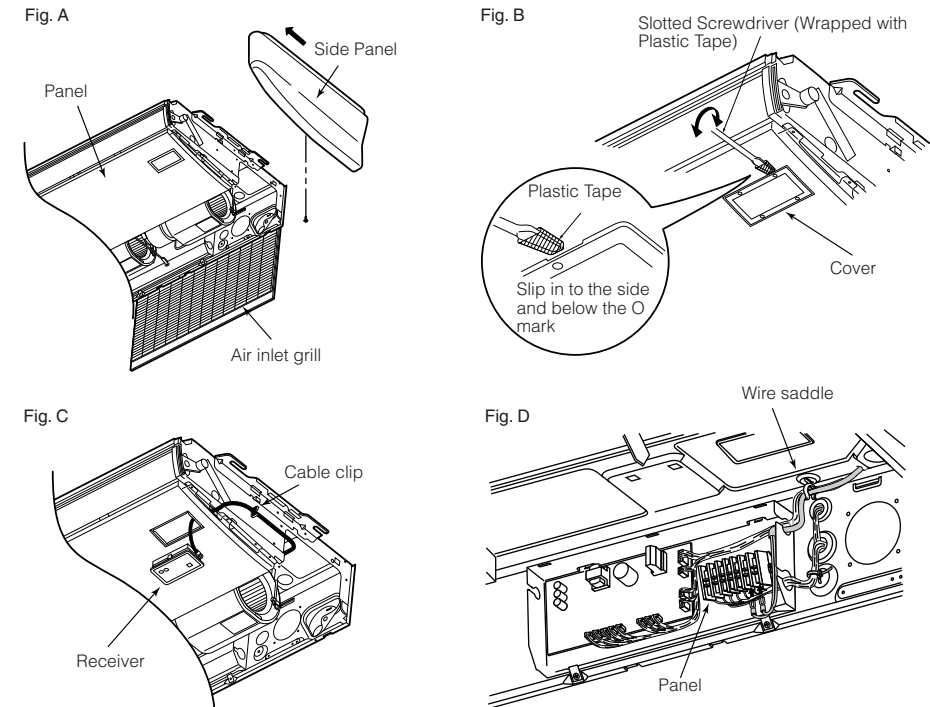

1-Way Cassette Type

- 1 While spreading the tabs of the cover, pull it out from the panel to the front. (Fig. A)
 - 2 Pass the lead wire through the panel and install the receiver in the hole in the panel. (The projecting parts of the receiver hold it in the hole in the panel.)
 - 3 Press the lead wire from the receiver in along the rib on the back of the panel. If installing to a unidirectional high ceiling cassette, pass it through the cutout. (Fig. B)
 - 4 Install the panel on the indoor unit.
 - 5 Fasten the lead wire sticking out from the panel with the cable clips on the inside of the indoor unit. (Fig. C)
 - 6 Draw the lead wire into the electrical box through the hole on the bottom and connect it to the remote control terminal strip.
- If installing to a high ceiling unidirectional cassette, fasten the wire at the latch of the fan casing with the enclosed cable tie. (Fig. D)

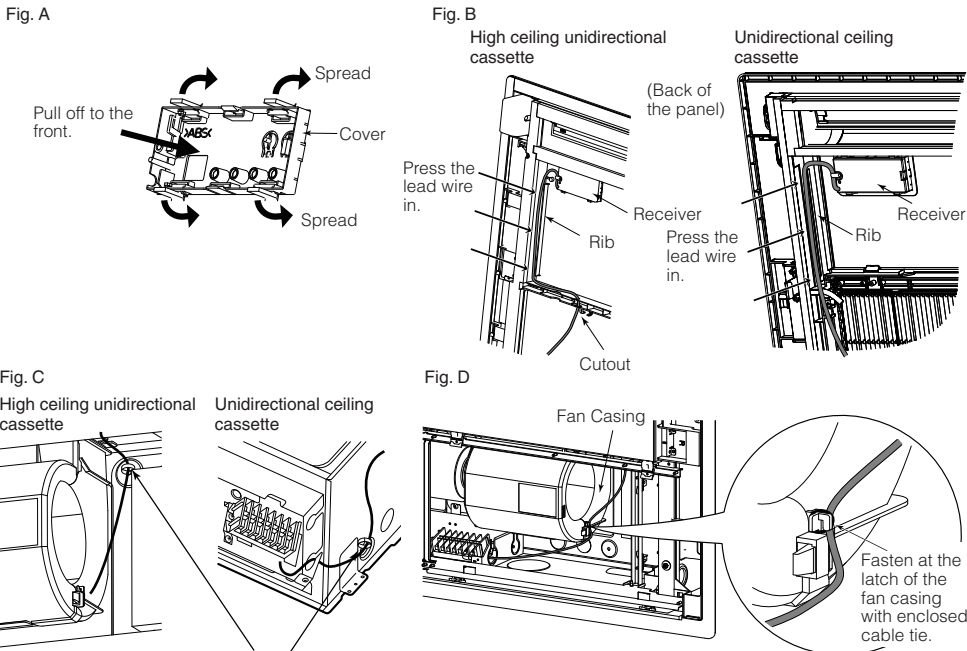

- <Note 1> If the wiring for the receiver is bundled with other wires, such as the incoming line, it may cause a malfunction, so avoid putting them together.
- <Note 2> Fasten the lead wire securely so it does not get wrapped up in the fan.
- <Note 3> If something causes the unit's power source to make noise, it will be necessary to resolve the problem, such as by installing a noise filter.
- For more information about wiring or test operation, refer to Wiring the Receiver and Test Run.

Wiring the Receiver

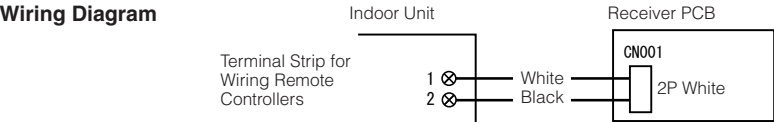

Connections
Connect the wires from the receiver to the remote control terminal strip on the indoor unit. (Polarity does not matter.)

Test Operation

Implementing a Test Run

1. Turn the #1 DIP switch [S003] on the receiver's PCB from OFF to ON and operate the wireless remote controller with its Start/Stop button.
2. During a test run, all display lamps on the display will light up.
3. During a test run, it is not possible to adjust the temperature.
4. After completing a test run, be absolutely sure to turn the #1 DIP switch from ON to OFF and make sure none of the display lamps are blinking. Also, replace the PCB cover back as it was and fasten it; while holding the wiring with the cable clamp, tighten its screw.

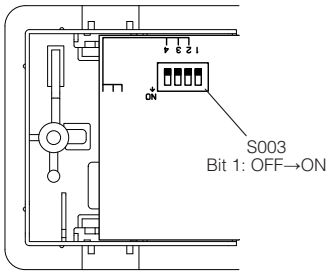



<Note 1> This is hard on the device, so only use this for the test run.

<Note 2> After turning on the power, the unit will not receive any commands from the remote controller for about 1 minute. This is not an error. (In fact it does receive signals, but they are cancelled.)

Setting Address Switches

- When more than one receiver and remote controller are installed in the same room, setting up addresses allows them to avoid interfering with each other.
- Refer to the Operating Instructions for information on how to change the addresses of the remote controllers.
- Changing the address of a receiver can be done after removing the screw to the receiver's PCB cover. Once the change is complete, put the cover back in place; while holding the wiring with the cable clamp, tighten its screw.

Address Display on the Remote Controller	AL L	1	2	6
Position of the Receiver's Address Switch	It doesn't matter where the receiver's address switch is.			

The Self-Diagnosis Function Display and What is Detected

Alarm Display in the table below indicates the content of alarms that are displayed when a wired remote controller is connected. For information on how to deal with the alarms, refer to the Mounting Instructions for the indoor unit or to Test Run or servicing materials.

Error Detected		WL Remote Control LED Display			
	Alarm Display	Run	Timer	Standby	Blinking
Communication error in the remote control circuit	E01-E03, E08-E14, E17, E18	●	●	●	
Communication error either in the in/ outdoor operation line or the sub-bus of the outdoor unit	E04-E07, E15, E16, E19-E31	●	●	○	
Operation of indoor protection device	P01, P09-P14	●	○	○	Alternately
Operation of outdoor protection device	P02-P08, P15-P31	○	●	○	Alternately
Error in the indoor thermistor	F01-F03, F10-F11	○	○	●	Alternately
Error in the outdoor thermistor	F04-F09, F12-F28	○	○	○	Alternately
Error in the indoor EEPROM	F29	○	○	●	Simultaneously
Error in the outdoor EEPROM	F30, F31	○	○	○	Simultaneously
Error related to the compressor	H01-H31	●	○	●	
Error in indoor settings	L01-L03, L05-L09	○	●	○	Simultaneously
Error in outdoor settings	L04, L10-L31	○	○	○	Simultaneously
Inconsistency in Air/Heat (Including an auto-temp setting for a model without auto-temp settings)		○	○	○	Alternately
Oil Alarm (Same as operation of outdoor protection device)		○	●	○	Alternately
Test Run		○	○	○	Simultaneously

● : Off / ○ : On / ◎ : Blinking (0.5 sec. intervals)

Room Temperature Sensor Settings

Common to All Models

- The indoor unit and the wireless remote controller are equipped with indoor temperature sensors. The sensing of indoor temperature works via one of them.
- When the unit is shipped, it is set to the indoor unit, but to switch to the remote controller, press the sensor button (diagram at right) inside the remote controller's cover and then check to make sure that Main Sensor on the LCD screen goes off.

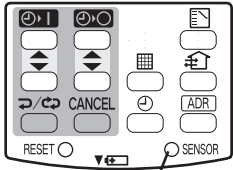

Sensor Button





<Note> Even when the sensor switch has been set to the remote controller, if the unit does not receive any room temperature data from the remote controller for ten minutes, it automatically switches back to the indoor unit sensor, so be sure to install the remote controller facing the receiver.

Setting Up Remote Control Functions

The functions of the wireless remote can be set on site.
(These settings are saved in nonvolatile memory in the remote controller, so even when its batteries are changed, the settings do not revert to the defaults.)

<Note> The operation of the air conditioner can be impacted, depending on the settings made, so only service personnel should make the settings.
Furthermore, making changes to these settings may cause actual operation to deviate from what is printed in the Operating Instructions, so be sure to explain this to the customer fully.

Making Settings (Do with unit stopped.)

1. Holding down the Swing/Wind Direction + OFF Timer  + Mode Select buttons at the same time for 4 or more seconds makes the display switch to the setting screen. (See Diagram Below.)
2. Use the Temperature setting buttons,  / , to select the number of the item to be set.
3. Use the ON Timer buttons,  / , to change settings.
4. The settings are saved with the Once/Every Day button. When this is done, the settings display of the LCD changes from blinking to light.
5. If other settings are to be changed as well, repeat steps 2 to 4.
6. When all settings have been made, press the Start/Stop button.

Example: Operation mode setting screen

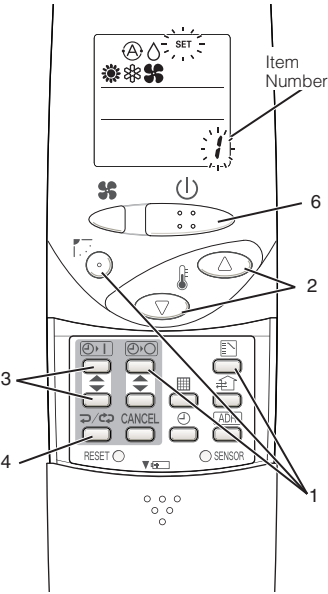

Item Number & Setting Item		Setting Content	Setting when Shipped
1	Operation Mode	→ → → → →	
2	Flap Display	→ → → (No Display) (Note 1)	
3	Select Fan Speed	→ → → (No Display)	
4	Display of Set Temperature	°F → Setting Off (Note 2) → °C	°F
5	Time Display	AM/PM → 24 Hour (No Display)	AM/PM
6	Ventilation Fan ON/OFF	Off (No Display) → On	OFF (Note 3)
7	Cool temp Max	41 – 95°F	86°F
8	Cool temp Min	41 – 95°F	64°F
9	Heat temp Max	41 – 95°F	78°F (Note 4)
10	Heat temp Min	41 – 95°F	60°F
11	Dry temp Max	41 – 95°F	86°F
12	Dry temp Min	41 – 95°F	64°F
13	Auto temp Max	41 – 95°F	80°F
14	Auto temp Min	41 – 95°F	62°F
16	Address Setting Max Value	00 (ALL only) → 01 – 31	06 (Note 5)
17	Heat temp Max ON/OFF	JP (Heater Max Temp Change Off) → EP (On)	JP

- | | |
|--------|--|
| Note 1 | While the unit is in the swinging mode (Swing/Wind Direction), the flap cannot be stopped in a desired position. |
| Note 2 | When Setting OFF is selected, "°C" is displayed on the LCD screen. |
| Note 3 | You can toggle between ON and OFF by pressing Ventilation for 4 seconds or more. |
| Note 4 | If the Heater Max ON/OFF setting is not changed to EP (ON), the setting change will not be reflected. |
| Note 5 | This is the number of addresses that can be set in the address change mode. Do not set it to 07 or above. |